



W11



# APU®

PROFILES FOR COMPOUND HEAT INSULATION SYSTEMS

## Corner bead with mesh

# DUO-TEX

With smooth or knurled skimming edge  
and 2 x mesh 12.5 cm

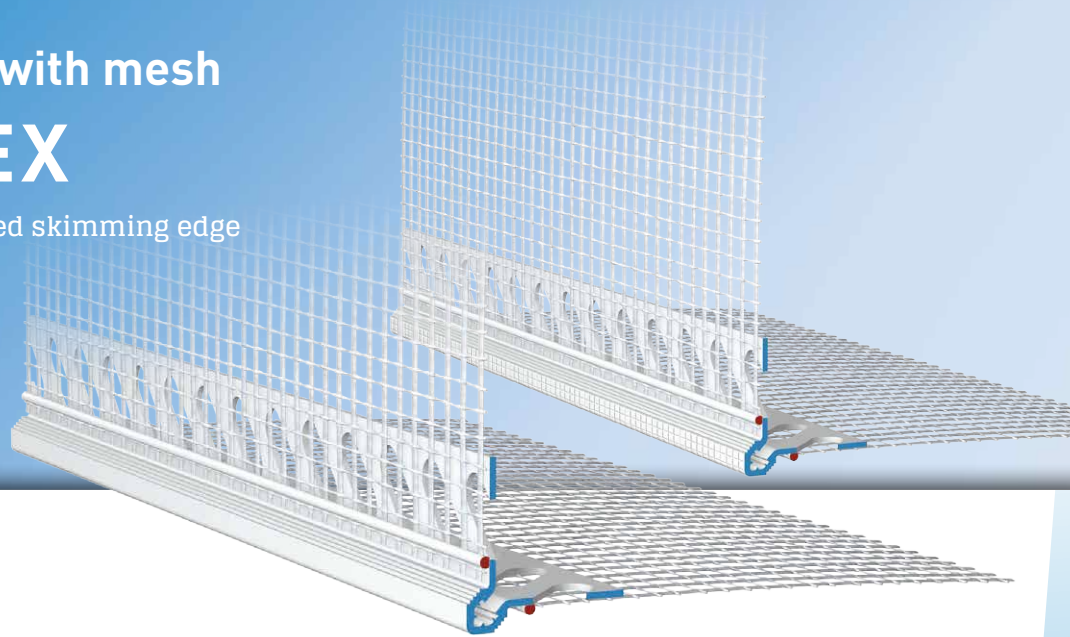

The **APU corner bead with mesh DUO-TEX** is used in compound heat insulation systems as a flush, impact-protected edge for thin top layers of plaster.

The corner bracket has 2 perforated wings to each of which a strip of mesh is welded. Each bar has a fabric overhang on one side of 10cm in the lengthways direction. The filler filaments serve as a skimming bar for the reinforcement base plaster. The skimming edge is offered in 2 versions (smooth edge for visible / painted over finish – knurled edge for plastering over) and ensures the correct application thickness of the entire plaster system. The plug connectors provided (Z13) enable the profiles to be connected together flush with each other.

Upon completion of the plastering work what is produced is a clean plaster corner.

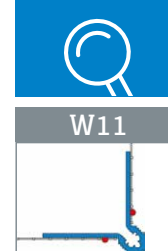

## Design

	ITEM NO.	LENGTH	PACKAGING UNIT	WEIGHT (per PU)
--	----------	--------	----------------	-----------------

### DUO-TEX corner bead with mesh

W11

With 2 x 12.5 cm mesh

Smooth skimming edge	<b>W11-2000</b>	2.0 m	25 bars = 50 m	7.5 kg
Knurled skimming edge	<b>W11-2050</b>	2.0 m	25 bars = 50 m	6.9 kg
	<b>W11-2550</b>	2.5 m	25 bars = 62.5 m	8.6 kg

## Features

	DUO-TEX CORNER BEAD WITH MESH
Material	<ul style="list-style-type: none"> <li>■ Rigid PVC manufactured under DIN-16941</li> </ul>
Mesh	<ul style="list-style-type: none"> <li>■ Min. 160 g/m<sup>2</sup> approved for compound heat insulation systems</li> <li>■ 2 x 12.5 cm wide – MW 4x4 mm</li> <li>■ Ultrasonic welded</li> </ul>
Accessories	<ul style="list-style-type: none"> <li>■ Z13-0000 Plug connectors (1 bag)</li> </ul>

## Important information

Storage	Always store profiles laid down in a dry place.
Other applications	Any applications not clearly described in the documents may be implemented only after consultation with the plaster or ETICS manufacturer.

For information on materials, areas of use, tests and correct application, please refer to our 'General Advice and Information'

## Details

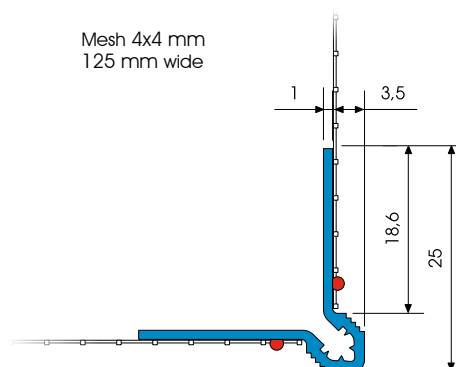

Sectional drawing in mm

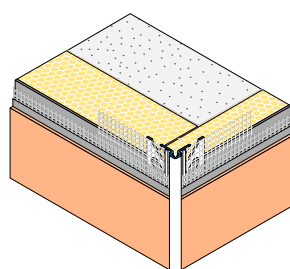

Application drawing W11 (drawing with visible profile edge)

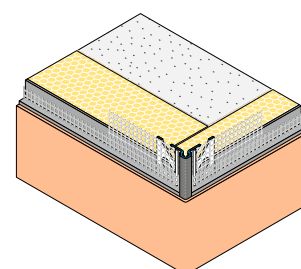

Application drawing W11-cod (drawing with profile edge that can be plastered over)